

## D1021M— Ultra 32 Gallon Perforated Steel Receptacle with Contour Top

### 32-gallon perforated steel receptacle with contour top and plastic liner



#### Material

The 32-gallon receptacle is 30.12" tall and is composed of 12-gauge perforated steel with a .56" diameter uniform hole pattern. The contour top is made of 18-gauge galvanized spun steel and features a 10" diameter waste opening for easy trash disposal and includes a 14" security strap.

The receptacle is designed to be portable for flexibility in placement or surface mounted using pre-drilled .38" diameter holes inside the base to prevent movement; optional corkscrew anchor also available. Includes a reusable plastic liner made of high-density black polyethylene.

#### Finish

Receptacle body is protected by the patented Fusion Advantage™ finish. The plastisol coating has an average thickness of .125" and is encapsulated with a richly tinted, high performance powder coating that won't rust, fade, peel, chip, crack, mold or mildew. The finish has been tested to the requirements of ASTM E1354 and determined to be compliant with California Uniform Fire Code 1103.2.1.4.2.

Fade-resistant, powder coated steel top features a state-of-the-art primer proven to prevent rusting. Treated components exceed the industry standard by 34% in testing by independent sources.

#### Color

See website or sales representative for color choices.

#### Assembly

Attachment of the top to the receptacle body requires minor assembly. Mounting options may require additional assembly when purchased.

#### Maintenance

The product is virtually maintenance-free and requires only periodic cleaning with a sponge and a solution of mild detergent and water to remove surface dirt. Do not clean with solvent or petroleum base products.

#### Warranty

20-year limited structural warranty with 7-year finish warranty from the date of purchase. See full details on multi-year warranties for components at [www.anovafurnishings.com/warranty.aspx](http://www.anovafurnishings.com/warranty.aspx).

#### Replacement Parts

Black Plastic Liner	F1017
Universal Contour Top	F3005

#### Accessories

Traditional Inground Mount	F1094
Traditional Surface Mount	F1098
45° Roadside Surface Mount	F1406
45° Roadside Inground Mount	F1407
Corkscrew Anchor	A1020

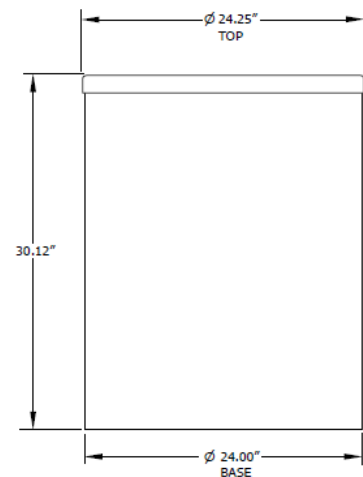
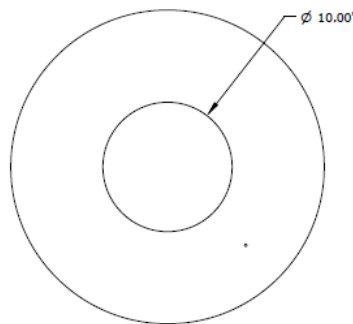
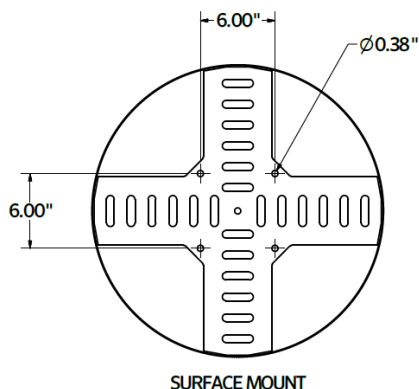

### SHIPPING INFORMATION

Unit Weight	Unit Shipping Wt. UPS	Unit Shipping Wt. Truck (1Units)	Unit Ship Size w/Pallet	Max Units Per Pallet	Pallet Size/Wt. (48" x 32")	Total No. Pkgs.	Shipping Class
78 lbs.	N/A	90 lbs./unit	32 cu. ft.	8	50 lbs.	1	100